



PO Box 31397
 Bellingham Wa 98228-3517
 (t) 360-752-1610 • 888-841-1810
 (f) 360-752-1612 • 888-841-1812

CEDARLINE EXTERIOR SERIES

HW KIT # 94-H511

PARTS LIST

- A. Cross Bar
- B. 1" Machine Screws (2)
- C. Cap Nut
- D. Threaded Pipe
- E. Fixture Body
- F. Wire Connectors (2)
- G. Socket Cup
- H. Glass Holder
- I. Image Set
- J. Glass
- K. White Die Cast Ring

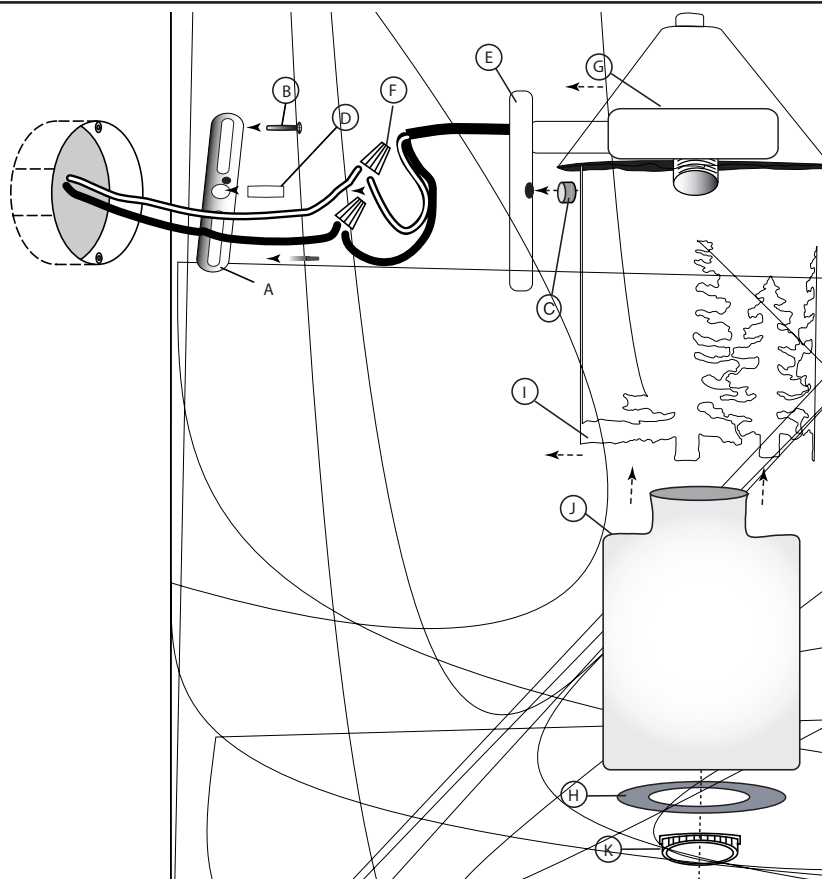

GENERAL

1. To ensure the success of the installation, be sure to read these instructions and review the diagrams thoroughly before beginning.
2. All electrical connections must be in accordance with local codes, ordinances, or the National Electrical Code. If you are unfamiliar with methods of installing electrical wiring, secure the services of a qualified licensed electrician.
3. These fixtures are intended to be mounted to a minimum 4" x 1-1/8" deep round outlet box. The box must be directly supported by the building structure.
4. **Before starting the installation, disconnect the power by turning off the circuit breaker or by removing the fuse at the fuse box. Turning the power off using the light switch is not sufficient to prevent electrical shock.**

NOTE: The important safeguards and instructions appearing in these instructions are not meant to cover all possible conditions and situations that may occur. It must be understood that common sense, caution, and care are factors, which cannot be built into any product. These factors must be supplied by the person(s) caring for and operating the fixture.

WIRING AND INSTALLATION

1. Attach the cross bar (A) to the junction box using the machine screws (B).
2. Thread on the threaded pipe (D) into the center hole of the cross bars (A).
3. Hold the fixture up to the junction box. Using the wire connectors (F), connect the white supply wire to the white fixture wire. Connect the black supply wire to the black fixture wire. Be sure no bare wires are exposed.
4. Slip the 3/8" hole in the fixture body (E) over the threaded pipe (D). Secure by using the cap nut (C).
5. Hold the fixture body (E) firmly against the wall while spreading silicone around the plate covering the junction box.
6. Let silicone cure as recommended on product used.
7. Once secure, install glass (J) by slipping the glass (J) through the center of the lower image set (I). Secure the glass (J) by using the glass holder (H) and the white die cast ring (K). Do not over tighten as the glass may break.
8. Electricity may now be restored.

LIMITED 2-YEAR WARRANTY: Cedar Valley Lighting warrants that its products are free of defects in workmanship and materials for a period of two years from date of purchase. If within two years from date of purchase any of its products are found defective in workmanship or materials, Cedar Valley Lighting will repair or replace, at its sole option, the defective product upon presentation of proof of purchase and the defective product.

THIS WARRANTY IS IN LIEU OF ALL OTHER WARRANTIES INCLUDING, WITHOUT LIMITATION, ANY IMPLIED WARRANTIES OF MERCHANTABILITY OR FITNESS FOR A PARTICULAR PURPOSE. Cedar Valley Lighting's liability under any warranty, whether express or implied, is LIMITED SOLELY TO THE REPAIR OR REPLACEMENT OF THE DEFECTIVE PRODUCT FOR THE DURATION OF THIS WARRANTY AND DOES NOT INCLUDE LABOR OR OTHER CONSEQUENTIAL OR INCIDENTAL DAMAGES.